

**HEAVY DUTY ASSEMBLED**

# Aluminum Picket Railing

Meets OSHA, ADA and ICC Safety Criteria

**SERIES**

**9000**

**New**

## Product Presentation

Superior's new Series 9000 Heavy Duty Aluminum Assembled Picket Railing offers the most attractive and innovative railing design available on the market today. This Assembled Picket Railing was specifically developed to conceal all exposed picket screw heads in the top and bottom rail assemblies and eliminate level and ramp rail post brackets.

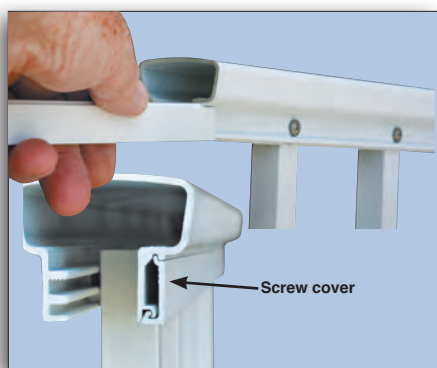

When the assembled top and bottom rails are positioned into the matching machined post openings, the result is a clean rigid design. Other major advantages of this design include quick turn around time and overall savings to the customer.



Series 9000

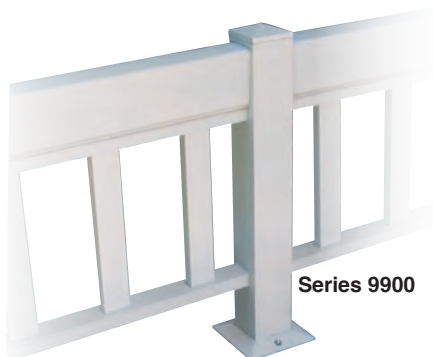

Series 9900



Series 9550

Superior Series 9000 Assembled Picket Railing is available in 6 feet lengths and custom lengths in 2-line or 3-line styles. Both styles are available in a wide range of heights. See other design styles and options on our website. The railing can meet step railing requirements by specifying the riser and tread dimensions of the steps. Swivel brackets are required for step rail applications. If railing is angled horizontally, specify the angle so the proper openings can be machined in the post for top and bottom rail insertions.

Custom railing lengths, continuous top rail with crossover post and other special construction ideas are also available.

All posts are 2-1/2" square and pickets are 3/4" square, with standard picket spacing on 4-1/2" centers. The top rail has a code approved 2" wide gripping surface for ramps, stairs or on horizontal railing.

Also available is the Series 9900 with a 2" wide x 4" high top rail and pickets 1-1/2" wide x 3/4", and has the no-maintenance qualities of aluminum. The Series 9550 3-line style (level rail only) features a 1-1/2" Schedule 40 round top rail, with an outside diameter of 1.90".



***Strong, Durable and Maintenance-Free Beauty!***

# Easy Assembly and Installation

SERIES

9000



All post are machined with openings to receive the top and bottom rails. The end post are machined on one side. The section post are machined on opposite sides and the corner post are machined with openings at 90°.

A variety of post styles, wall plates, horizontal or vertical swivels and/or gates can also be available to fit any railing application.

As Assembled Picket Railing is inserted in post machined openings, rail wedges located in bottom rails will assure proper rail insertion of 1-1/4" beyond the post machined opening inside the post.



Predrilled rail tabs are provided with the post to connect the top rails (shown in photos at far left). If a railing section or sections need to be shortened, simply saw an equal amount from each railing end with the use of a miter or circular saw. Reinstall and tighten the rail wedge using a 1/8" Allen Wrench on the bottom rail so 1-1/4" protrudes through the post openings (shown in photos on the right). Next, connect the two top rails together with a rail tab, and drive the post cap in place with a rubber mallet.

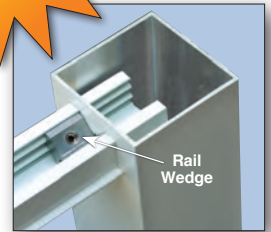

View of the underside of the bottom rail to show the location of rail wedge above and in photos below.

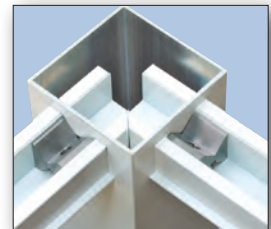

**You'll save time and money with the ease of installation of this railing!**

## Finishes

Smart, decorative finishes add a distinctive touch to any building. Whether baked-on enamel, clear anodized or duranodic, these finishes are guaranteed to endure for years of continued service and maintenance-free beauty.

